



AS-T10G3

Quick Installation Guide

For AS67 / AS65R / AS71R Series

Table of Contents

1. Notices	3
2. Package Contents	4
3. Installation Guide	5
3.1. Parts and Tools Needed	5
3.2. AS-T10G3 installation guide	5
3.3. Installing in the AS67 Series	6
3.4. Installing in the AS65R Series	12
3.5. Installing in the AS71R Series	16
4. Appendix.....	21
4.1. Troubleshooting	21
4.2. Contact ASUSTOR Technical Support	21

1. Notices



Federal Communications Commission Statement

This device complies with FCC Rules Part 15. Operation is subject to the following two conditions:

- ➔ This device may not cause harmful interference.
 - ➔ This device must accept any interference received, including interference that may cause undesired operation.
- This equipment has been tested and found to comply with the limits for a class A digital device, pursuant to Part 15 of the Federal Communications Commission (FCC) rules. These limits are designed to provide reasonable protection against harmful interference in a residential installation. This equipment generates, uses, and can radiate radio frequency energy and, if not installed and used in accordance with the instructions, may cause harmful interference to radio communications. However, there is no guarantee that interference will not occur in a particular installation. If this equipment does cause harmful interference to radio or television reception, which can be determined by turning the equipment off and on, the user is encouraged to try to correct the interference by one or more of the following measures:

- ➔ Reorient or relocate the receiving antenna.
- ➔ Increase the separation between the equipment and receiver.
- ➔ Connect the equipment into an outlet on a circuit different from that to which the receiver is connected.
- ➔ Consult the dealer or an experienced radio/TV technician for help.

Changes or modifications not expressly approved by the party responsible for compliance could void the user's authority to operate the equipment.



CE Mark Warning



CE marking for devices without wireless LAN/Bluetooth

The shipped version of this device complies with the requirements of the EEC directives 2004/108/EC "Electromagnetic compatibility" and IEC60950-1:2005 (2nd Edition)+A1:2009 "Information technology equipment-Safety".

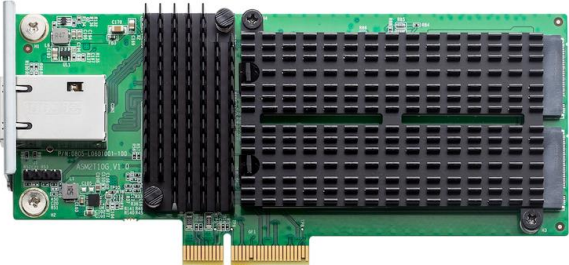
2. Package Contents

AS-T10G3 x1	Low-Profile Bracket x1
	
	<th data-bbox="863 611 1503 651">Full-Height x1</th>
	

3. Installation Guide

3.1. Parts and Tools Needed

Phillips head screwdriver

3.2. AS-T10G3 installation guide

Please refer to <https://www.asustor.com/service/compatibility> for more information on M.2 SSD compatibility.

1. Undo the heatsink screws on the AS-T10G3 expansion card.



2. Remove the protective covering on the heatsink thermal pad.

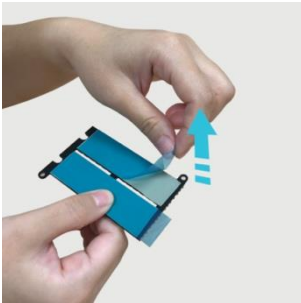

3. Insert the M.2 SSD into the slot at angle. Ensure the notch on the SSD connector is aligned with the slot. Insert the M.2 SSD into the slot and make sure the connector is fully inserted.



4. Bend back the lever slightly and press down on the SSD until the SSD is secure and flush with the PCB.

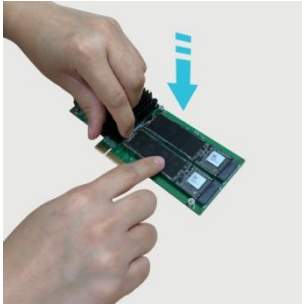

5. Fasten the heatsink screws onto the AS-T10G3.

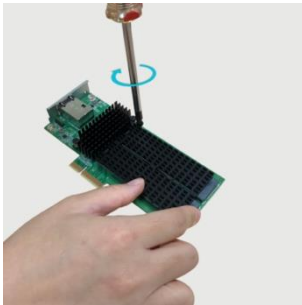

3.3. Installing in the AS67 Series

1. To add a 10-Gigabit Ethernet card, install ASUSTOR NAS PCIe Mode Switcher from App Central.

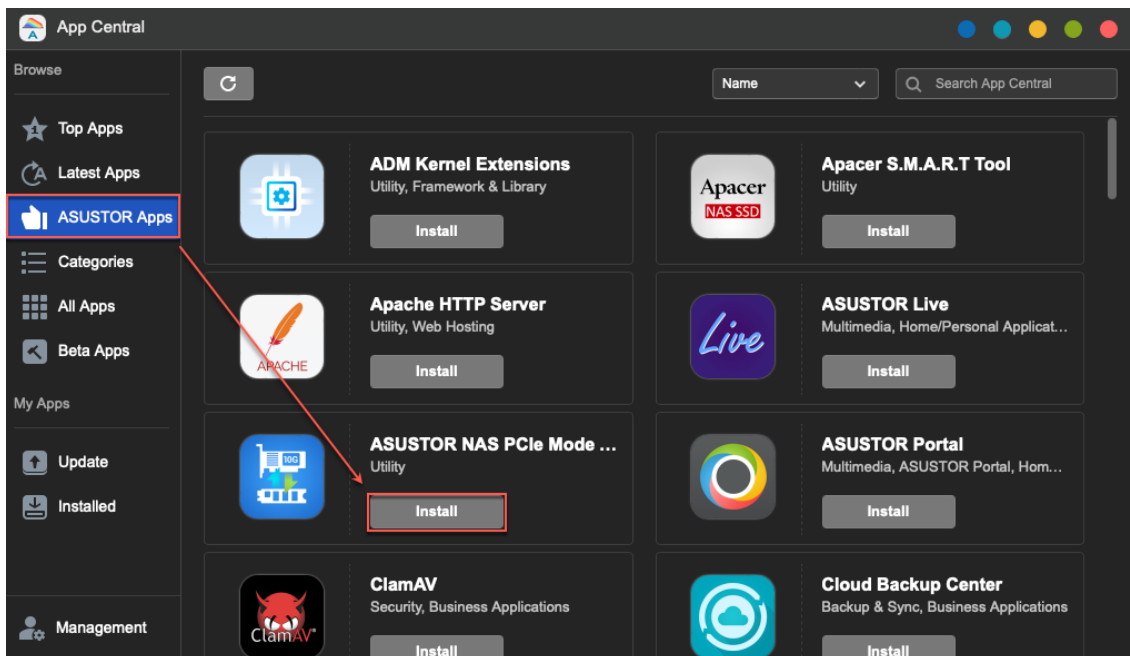

2. Select 10G NIC and press apply.

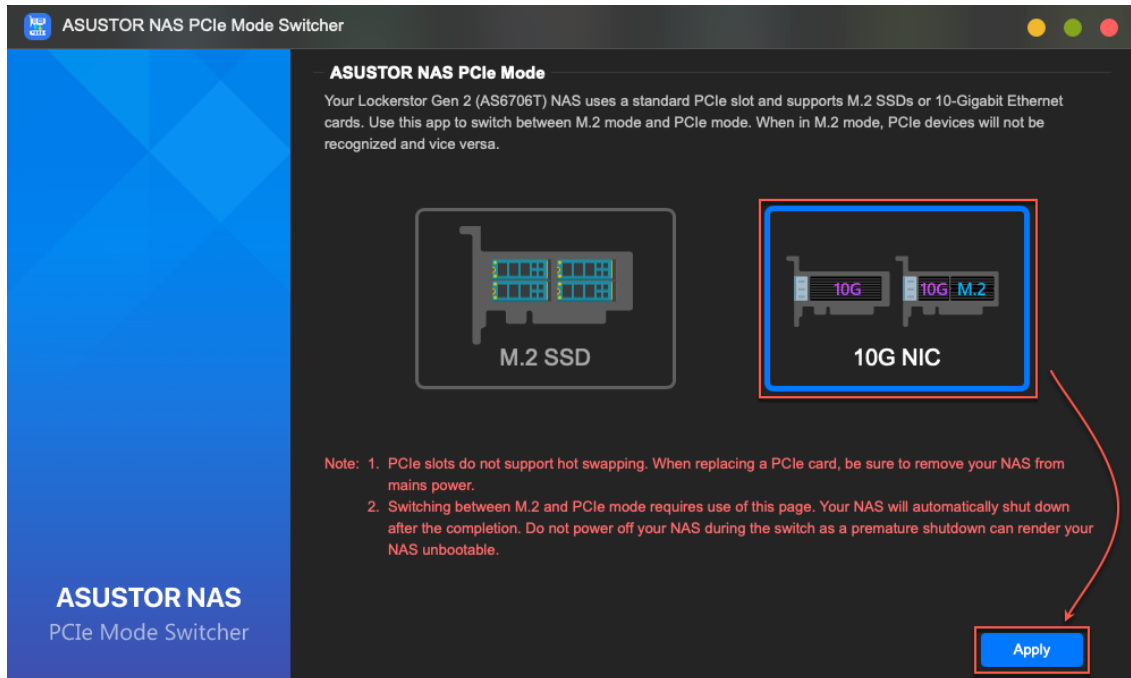

3. Click OK

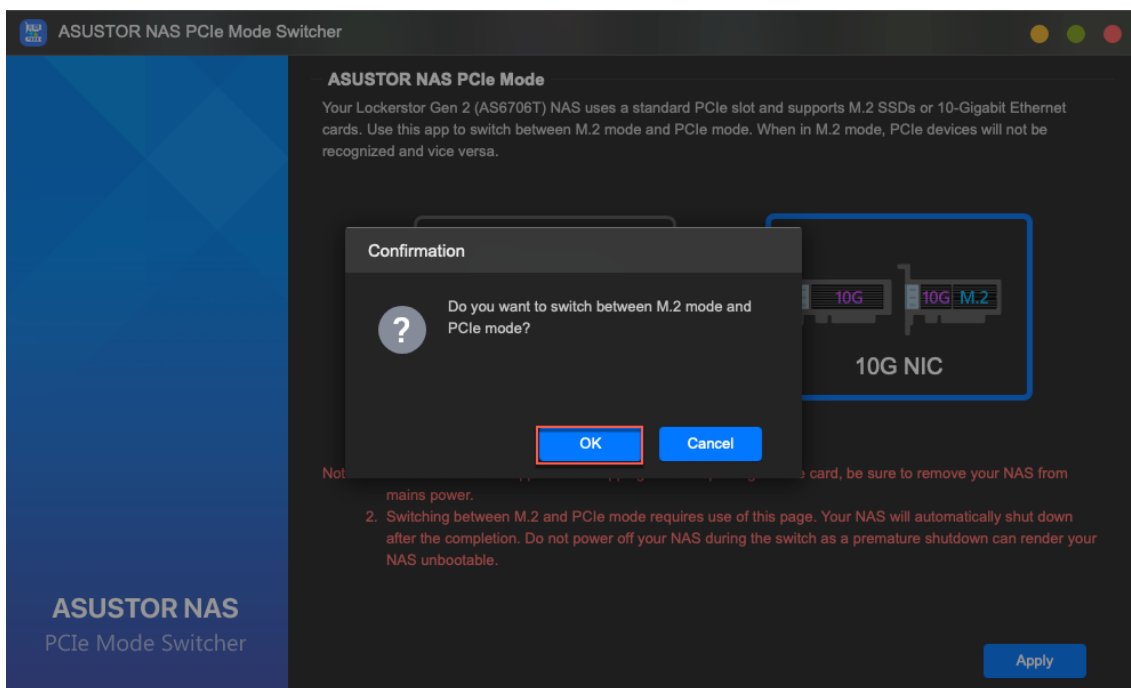

4. After confirmation, your NAS will shut down. After shutting down, you will now be able to install the 10-Gigabit Ethernet card after disconnecting your NAS from mains electricity.

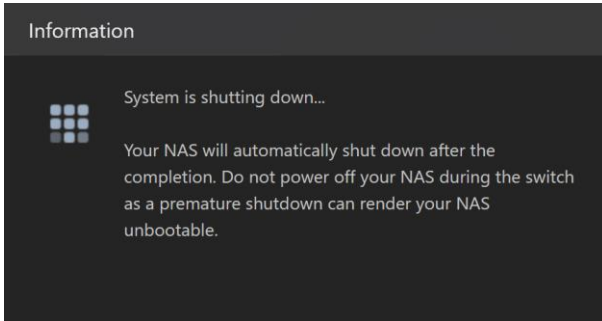

5. Disconnect all cables and devices connected to the NAS including the power cord.

AS6704T

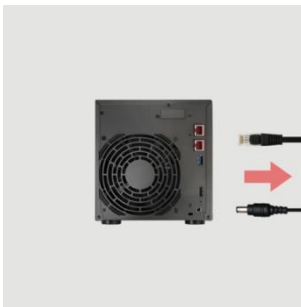

AS6706T



Note. The PCIe socket inside your NAS does not support hot swap functionality. Please shut down and unplug your NAS before changing between PCIe devices.

6. Use a screwdriver to loosen the three screws found on the rear of the NAS as shown in the illustration.

AS6704T



AS6706T



7. Grip the cover from both sides with two hands and then gently push it back to remove it from the chassis.
8. To remove the M.2 card, undo the screws as shown below.

AS6704T

AS6706T

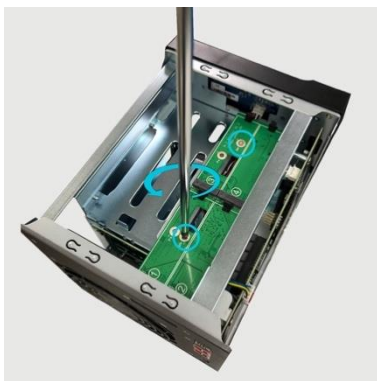

9. Gently pull the M.2 card from the PCIe slot as shown below.

AS6704T



AS6706T



10. Undo the two screws that hold the bracket for the M.2 card in place.

AS6704T

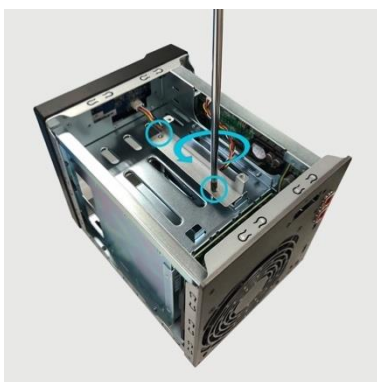

AS6706T



11. Lift the bracket out of the NAS.

AS6704T

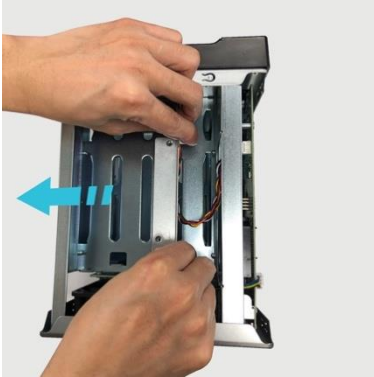

AS6706T



12. Remove both screws in the rear of the NAS and placeholder bracket.

AS6704T



AS6706T

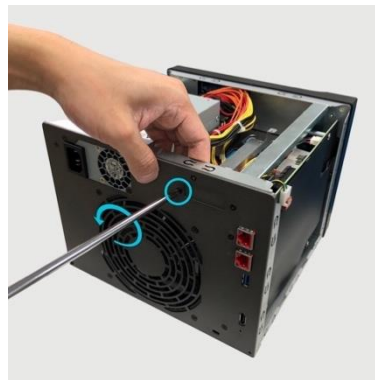

13. Gently insert the network card into the PCIe slot of your NAS.

AS6704T



AS6706T



14. Fasten the network card to the NAS with screws.

AS6704T



AS6706T



15. Follow these instructions in reverse order to reinstall the M.2 card.

16. Replace the cover and tighten the three screws that were removed previously.

AS6704T



AS6706T



17. Reconnect all cables including the power cord and then start up the NAS.

AS6704T

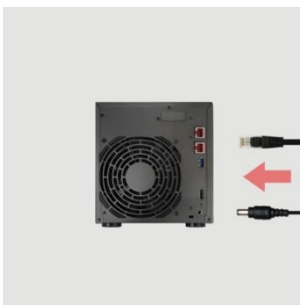

AS6706T



3.4. Installing in the AS65R Series

1. Disconnect all cables and devices connected to the NAS including the power cord.

AS6504RS



AS6504RD

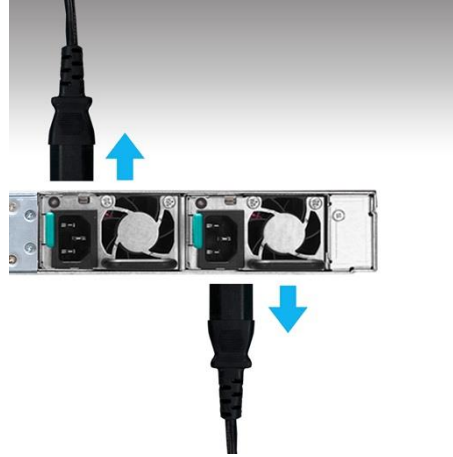

AS6512RD

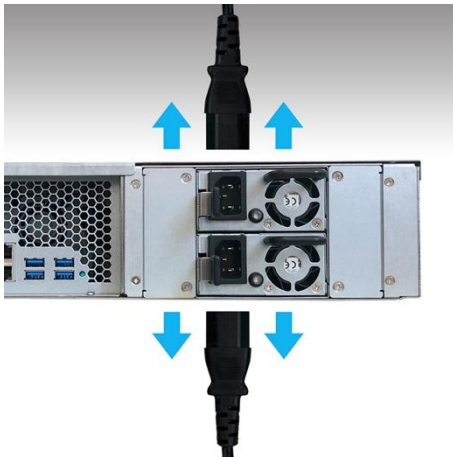

2. Use a screwdriver to loosen the three screws found on the rear of the NAS as shown in the illustration.

AS6504RS

AS6504RD

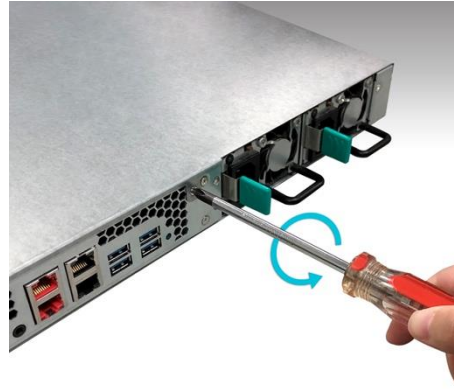

AS6512RD



3. Grip the cover from both sides with two hands and then gently push it back to remove it from the chassis.

AS6504RS/AS6504RD

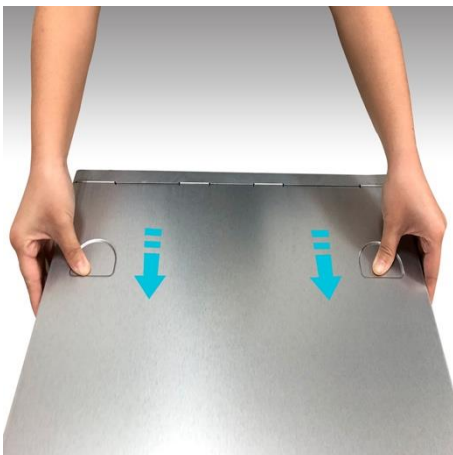

AS6512RD

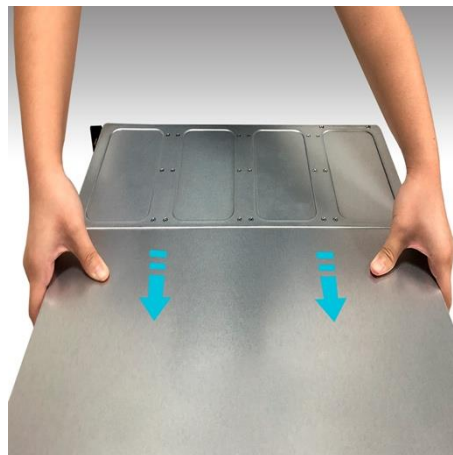

4. Unscrew the blanking plate retention screw and then remove the blanking plate for the expansion slot that you wish to use.

AS6504RD/AS6504RS



AS6512RD

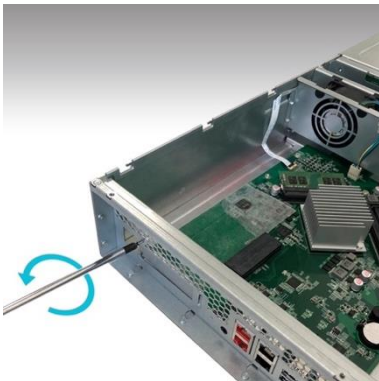

5. Undo the two screws holding the NAS-specific bracket in place.

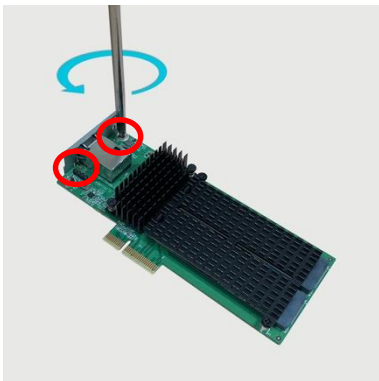

6. Install the half-height bracket onto the card and fasten the screws.

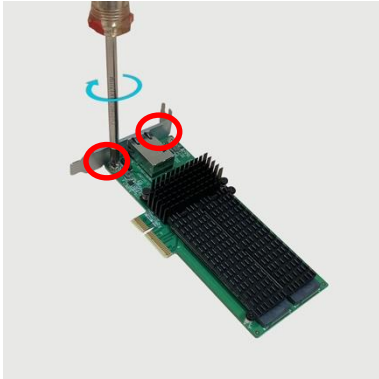

7. Carefully insert your expansion card into the slot, making sure to line up the connector on the bottom of the expansion card with the slot.



8. Replace the cover and tighten the three screws that were removed previously.

AS6504RS/AS6504RD

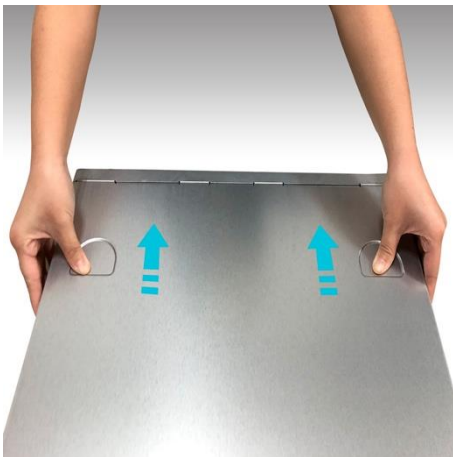

AS6512RD

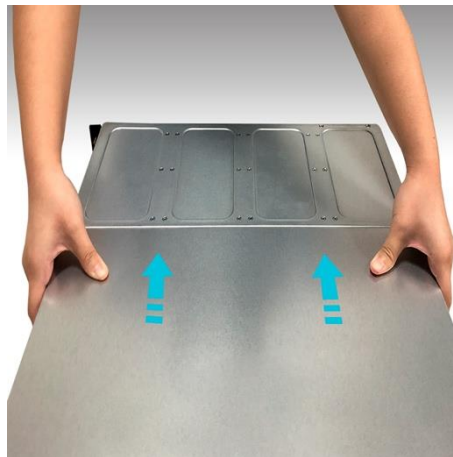

9. Reconnect all cables including the power cord and then start up the NAS.

AS6504RS

AS6504RD

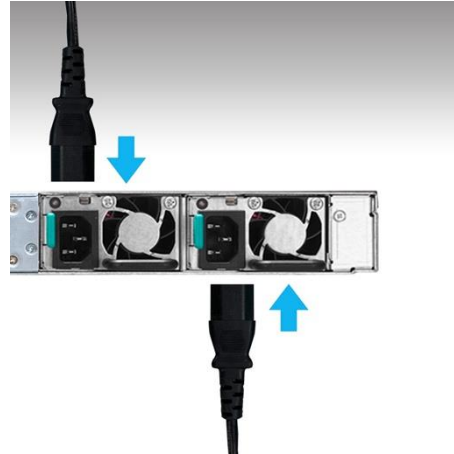

AS6512RD

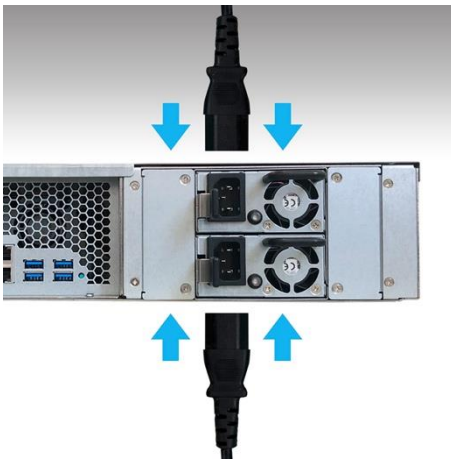

3.5. Installing in the AS71R Series

1. Disconnect all cables and devices connected to the NAS including the power cord.

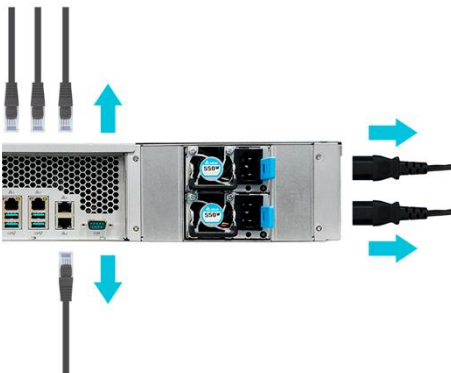

2. Use a screwdriver to loosen the three screws found on the rear of the NAS as shown in the illustration.



3. Grip the cover from both sides with two hands and then gently push it back to remove it from the chassis.



4. Unscrew the blanking plate retention screw and then remove the blanking plate for the expansion slot that you wish to use.



5. Installation instructions for the AS7112RDX using the half-height bracket.
 - Undo the two screws holding the NAS-specific bracket in place.

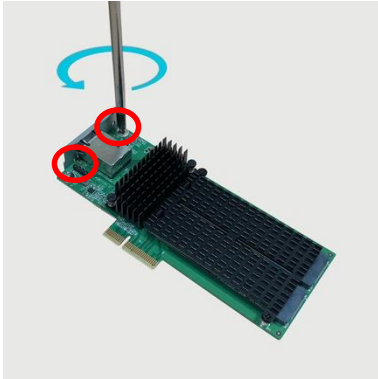

- Install the half-height bracket onto the card and fasten the screws.



6. Installing inside the AS7116RDX

- Undo the two screws holding the NAS-specific bracket in place.

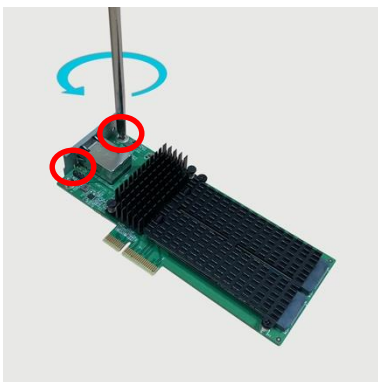

- Install the full-height bracket onto the card and fasten the screws.

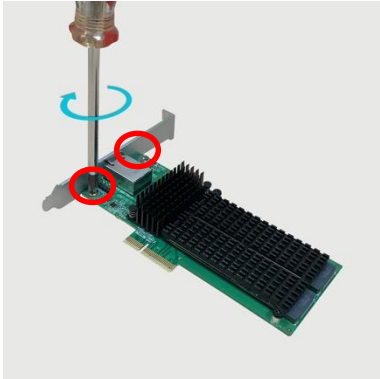

7. Please install the AS-T10G3 in order as described in the picture below.

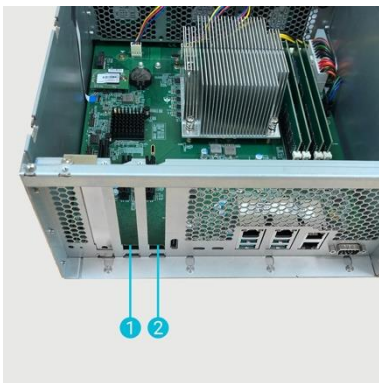

Note: Only a maximum of two cards can be installed at a time.

8. Gently lower the card into the slot and ensure that the connector makes full contact.



9. Using two fingers, carefully push the expansion card into place and then screw in the retention screw.



10. Replace the cover and tighten the three screws that were removed previously.



11. Reconnect all cables including the power cord and then start up the NAS.

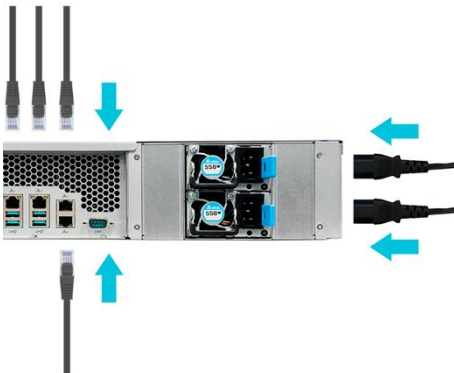

4. Appendix

4.1. Troubleshooting

Q: My NAS turns on but it does not detect the AS-T10G3. What should I do?

A: Please ensure you have switched your NAS to PCIe mode in ADM's PCIe Mode Switcher from App Central.

Q: After installing the AS-T10G3 into my NAS, my NAS is no longer starting up. What should I do?

A: Please follow the steps below to resolve this issue:

1. Check if the LED indicators, system buzzer, and LCD display panel are operating normally.
2. If your NAS is unable to recognize the network card or cannot be started up properly, please turn off the power, remove the NAS from mains electricity and remove the card. Attempt to turn on the NAS without the card.
3. If the previous steps have not solved your problem, please contact your local dealer or ASUSTOR customer service.

4.2. Contact ASUSTOR Technical Support

Contact us:

1. Email: support@asustor.com
2. Online Support Form: https://www.asustor.com/service/online_support
3. ASUSTOR Online Community: <https://forum.asustor.com/>